

PEOPLES STEEL MILLS LIMITED

Manghopir, Karachi.

REQUEST FOR QUOTATION



M/s.

RFQ NO. PSM/LP-44/PR-21128/22418

ISSUED ON 03-JAN-24

DUE ON 05-JAN-24

Dear Sirs,

We invite you to quote for the following material on F.O.R PSM site basis inclusive of all Government taxes and levies on the terms and conditions attached herewith valid for 45 days. Your offer must reach the office of the undersigned by the date mentioned above.

S. NO.	DESCRIPTION	QUANTITY	RATE
1	K+ NOTCHING INSERT RB12 Make China / Lot Imported in Good Condition is Acceptable	10 NOS	
2	K+ NOTCHING INSERT RB19.1 Make China / Lot Imported in Good Condition is Acceptable	15 NOS	
3	K+ NOTCHING INSERT RB25 Make China / Lot Imported in Good Condition is Acceptable	15 NOS	
4	K+ NOTCHING INSERT RB36 Make China / Lot Imported in Good Condition is Acceptable	10 NOS	
5	CBN TURNING INSERT RCGX 120700 GROOVING INSERT RCGX1207 S02020 - ATM400 - SOLID CBN - TURNING INSERT Make China / Lot Imported in Good Condition is Acceptable	25 NOS	
6	CBN TURNING INSERT RCGX 090700 GROOVING INSERT RCGX907 S02020 - ATM400 - SOLID CBN - TURNING INSERT Make China / Lot Imported in Good Condition is Acceptable	20 NOS	
7	CBN TURNING INSERT RCGX 060600 GROOVING INSERT RCGX0606 S02020 - ATM400 - SOLID CBN - TURNING INSERT Make China / Lot Imported in Good Condition is Acceptable	20 NOS	

- NOTE :**
1. Delivery immediate / ready stock after receipt of Purchase Order.
 2. Payment will be made within 45 days after acceptance of material.
 3. Offer must be sent to Attention of Head (Procurement) through Fax / Post / or Email:
m.naeem@psmltd.com, farrukh.khan@psmltd.com.

PEOPLES STEEL MILLS LIMITED

Manghopir, Karachi.

REQUEST FOR QUOTATION



Yours Sincerely
for PEOPLES STEEL MILLS LIMITED

Tool	Offered line	Code	Description		Specifications
T01 tool	R64	747125	CRDCN5040 12		Lu=17 OHX=53 B=40 H=50 LF=300 IC=12.7
T01 insert	R65	750752	RCGX 120700 T15015 650		
T03 tool	R66	747124	CRDCN5040 9		Lu=16.4 OHX=44.2 B=40 H=50 LF=300 IC=9.52
T03 insert	R67	805602	RCGX 090700 T01020 650		
T04 tool	R68	747123	CRDCN5040 6		Lu=15.2 OHX=34.5 B=40 H=50 LF=300 IC=6.35
T04 insert	R69	715284	RCGX 060600 T01020 650		
T19 tool	R70	748903	CRDCN5040 12 AR55		Lu=54.7 OHX=64.9 B=40 H=50 LF=300 IC=12.7
T19 insert	R71	750752	RCGX 120700 T15015 650		
T20 tool	R72	753219	CRDCN5040 6 AR55		Lu=53 OHX=63.7 B=40 H=50 LF=300 IC=6.35
T20 insert	R73	715284	RCGX 060600 T01020 650		
T36 tool	R74	788062	CRDCN5040 12 AR100		Lu=99.7 OHX=109.9 B=40 H=50 LF=300 IC=12.7
T36 insert	R75	750752	RCGX 120700 T15015 650		
T40 tool	R76	ATM.TURNING	CRDCN5040 6 AR40 SPECIAL		Lu=40 B=25 H=32 LF=170 IC=6.35
T40 insert	R77	715284	RCGX 060600 T01020 650		
T57 tool	R78	794203	SPECIAL RIGHT SIDE TURNING TOOL T57 AR60		CDX=60 B=40 H=40 LF=150 Re=1.58
T57 insert	R79	739498	150.23-031716 T01020 670		
T57 insert	R80	731920	150.23-031704 T01020 670		Re=0.38
T58 tool	R81	794204	SPECIAL LEFT SIDE TURNING TOOL T58 AR60		CDX=60 B=40 H=40 LF=150 Re=1.58
T58 insert	R82	739498	150.23-031716 T01020 670		
T76 support	R83	863212	TOOL BLOCK SUPPORT 151.2-3232-25		LF=120 OAH=54.5 OAW=50
T76 blade	R84	869055	BLADE N123H55-25A2		LF=150 OHX=55 WF=3.675
T76 insert	R85	869054	N123H1-040004501025 7015		REL=0.4 CW=4



PEOPLES STEEL MILLS LTD

Compilato da : Dalla Serra _____ Data 7/5/21
 Visto da _____ Data _____

NOMINAL DIA	CORE DIA	RIB HEIGHT	CREST WIDTH	FLANKS ANGLE	RIB ANGLE	RIB SPACING	ROLL DIA	N° of NOTCHES	effective Rib Spacing	GROOVE RADIUS	GROOVE DEPTH	E Rib	GROOVE WIDTH	NOTCH DIA	EFFECTIVE RIB ANGLE	TOOL DIA	TOOL LENGTH	SPINDLE DIA	SPINDLE DEPTH	SPACER	TOOL SETTING	N OF THREADS	LOCKING PIN DIA
ϕT	D	Hs	Bs	α	β	Cs	ϕR	Z	Cse	Rg	Gd	Gn	E	Nd	βe	Td	Tl	Sd	Bd	S	Ts	Zp	ϕP
12	11,64	0,65	1,2	75	60	7,8	340	137	7,796653	5,82	4,71		11,43	11,45	57,0	4	7,8	9,5	6,83		10,47	3,0	3,0
14	13,58	0,76	1,4	75	60	9,1	340	117	9,129415	6,79	5,5		13,33	13,36	56,9	5	9,2	11,5	8,27		12,43	3,0	4,0
16	15,52	0,86	1,6	75	60	10,4	340	103	10,37031	7,76	6,29		15,24	15,27	57,0	6	10,7	13	9,57		14,13	3,0	5,0
18	17,48	0,97	1,8	75	60	11,7	340	91	11,73782	8,73	7,07		17,14	17,18	56,9	6	11,7	14	10,11		15,59	3,0	5,0
19,1	18,53	1,03	1,91	75	60	12,4	340	86	12,42025	9,265	7,5		18,19	18,23	56,9	6	12,22	14	10,11	0,00	16,11	3,0	5,0
20	19,4	1,08	2	75	60	13	340	82	13,02612	9,7	7,86		19,05	19,09	56,9	8	14	16	12,46		17,54	3,0	6,0
22	21,34	1,19	2,2	75	60	14,3	340	75	14,24189	10,67	8,64		20,95	20,99	57,1	8	14,96	16	12,46	0,00	18,50	3,0	6,0
25	24,25	1,35	2,5	75	60	16,3	430	83	16,27572	12,125	9,82		23,81	23,86	56,9	8	16	20	14,07	0,00	21,93	3,0	6,0
25,4	24,64	1,37	2,54	75	60	16,5	430	82	16,47421	12,32	9,98		24,19	24,24	57,0	8	16,19	20	14,07	0,00	22,12	3,0	6,0
28	27,16	1,51	2,8	75	60	18,2	430	74	18,2552	13,58	11		26,67	26,72	56,9	10	19	23	17,14		24,86	3,0	8,0
32	31,04	1,73	3,2	75	60	20,8	430	65	20,78284	15,52	12,57		30,47	30,54	57,0	10	21	26	18,73		28,27	3,0	8,0
36	34,92	1,94	3,6	75	60	23,4	430	58	23,29112	17,46	14,14		34,28	34,35	57,1	10	25	29	22,32		31,68	3,0	8,0
40	38,8	2,16	4	75	60	26	510	62	25,84213	19,4	15,71		38,09	38,17	57,1	12	26	32	22,92		35,08	3,0	8,0
48	46,56	2,59	4,8	75	60	31,2	430	43	31,41593	23,28	18,86		45,71	45,81	56,8	14	30	39	26,60		42,40	3,0	8,0

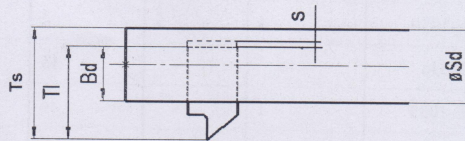
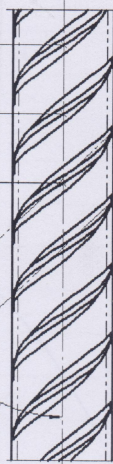
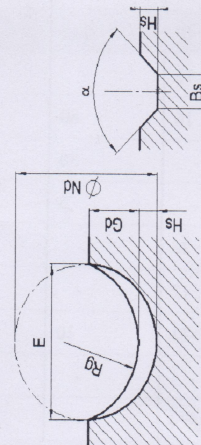

19-05-21 M. Comand Modified Rg Rb36



100-100-100





10585024

H 0.60 mm/(0.10-1.81) (00)
 p 0.24 in.(004-0.71)
 H 0.49 mm/r/(0.06-0.78)
 n 0.19 in./r/(0.06-0.78)
 v 115 m/m/min
 c 375 sfm

K 0.50-4.20 r/r/(0.60-9.90)
 n 0.90 mm/m/r/(0.60-9.90)
 p 0.90 mm/m/r/(0.60-9.90)
 v 475 m/m/min
 c 1565 sfm

H S N K M P
 ISO

RCGX 06.06 00T01020
 RCGX 24T0320
 650

762828070316

T Max

K 0.47 mm/(0.14-0.65)
 n 0.18 in/(0.06-0.26)
 v 540 m/m/min(700-465)
 c 1800 sfm(2300-1550)

H 0.31 mm/(0.1-0.46)
 n 0.12 in/(0.04-0.18)
 v 110 m/m/min(110-90)
 c 370 sfm(370-305)
 p 0.7 mm(0.1-1.1)
 a 0.28 m(0.04-0.55)

WARNING

Dust and mist hazard! Flying
 fragment hazard! Use approved
 personal protective equipment
www.ccoonant.com/safetyinfo
WARNING: Cancer -
www.P65Warnings.ca.gov

MfrID: 5740049
 Batch no: 0628000526
 Made in Japan



5505958535

T Max

K 0.71 mm/(0.14-0.86)
 n 0.23 in/(0.06-0.34)
 v 500 m/m/min(700-405)
 c 1650 sfm(2300-1300)

WARNING

Dust and mist hazard! Flying
 fragment hazard! Use approved
 personal protective equipment
www.ccoonant.com/safetyinfo
WARNING: Cancer -
www.P65Warnings.ca.gov

MfrID: 57400357
 Batch no: 1628010928
 Made in Japan



556949301

DECEM

13	8	7:10
17	5	6:40
21	5	7:14
25	5	7:16
29	5	7:18
31	5	7:19
3	6	7:19
7	6	7:19
11	6	7:19
15	6	7:19
19	6	7:19
23	6	7:19
27	6	7:19
31	6	7:19
3	7	7:19
7	7	7:19
11	7	7:19
15	7	7:19
19	7	7:19
23	7	7:19
27	7	7:19
31	7	7:19